

Wirecast Gear

Example Setups



Wirecast Gear Example Setups

There are many ways to set up Wirecast Gear. Here are just a few.

For more info, call us at +1 877 681 2088

Wirecast Gear is capable of running everything from very basic to very advanced productions. Here are some of the many ways Wirecast Gear can be setup.*

*NOTE: There are 3 different models of Wirecast Gear, the 110, 210, 230 which is noted in each example. Talk to a salesperson at +1 877 681 2088 if you have more questions about which model is right for you, or visit www.telestream.net for more info.

“Use What You’ve Got” | Basic HDMI + Mobile

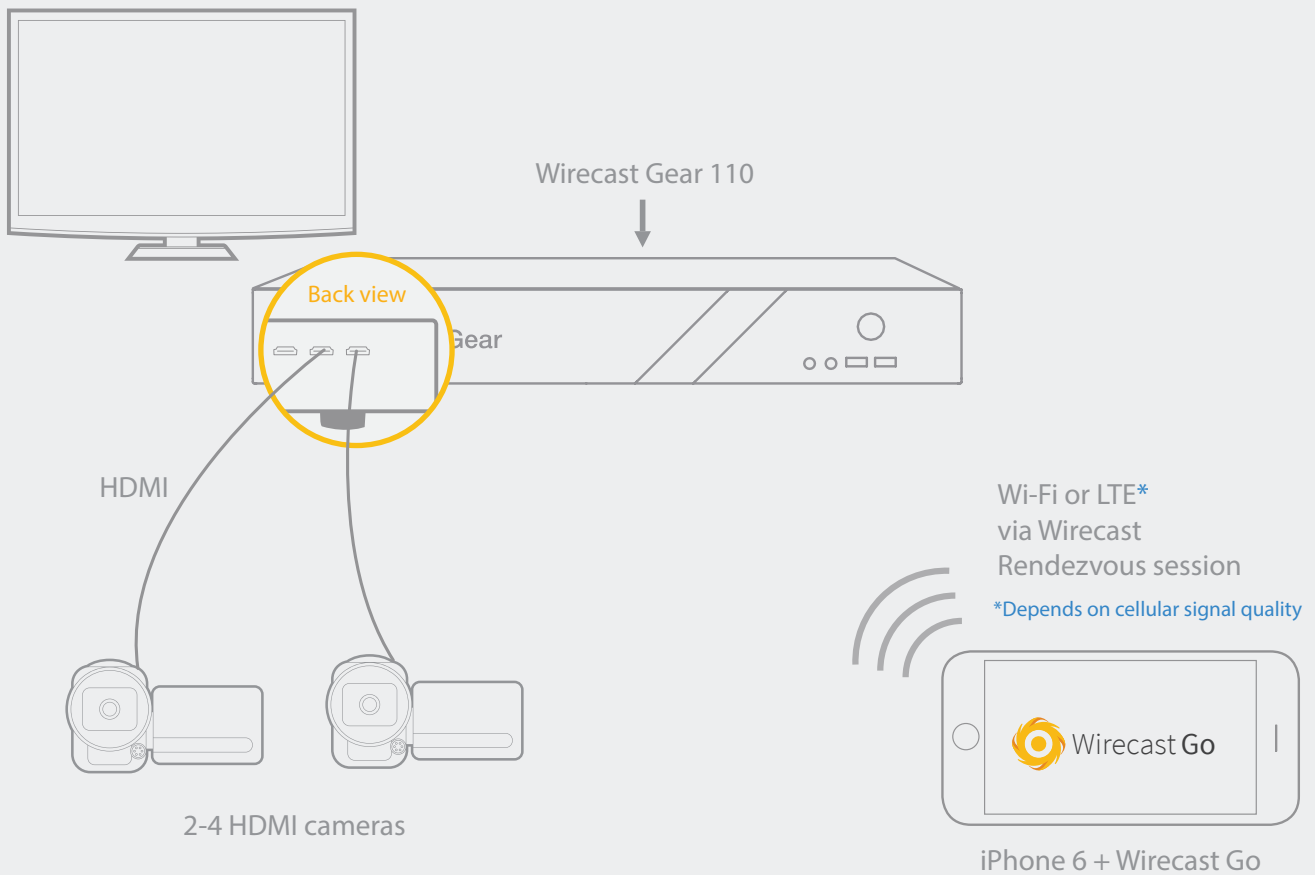

“One Man Band” | PTZ Optics Cameras

OPTION 1 (via Ethernet)

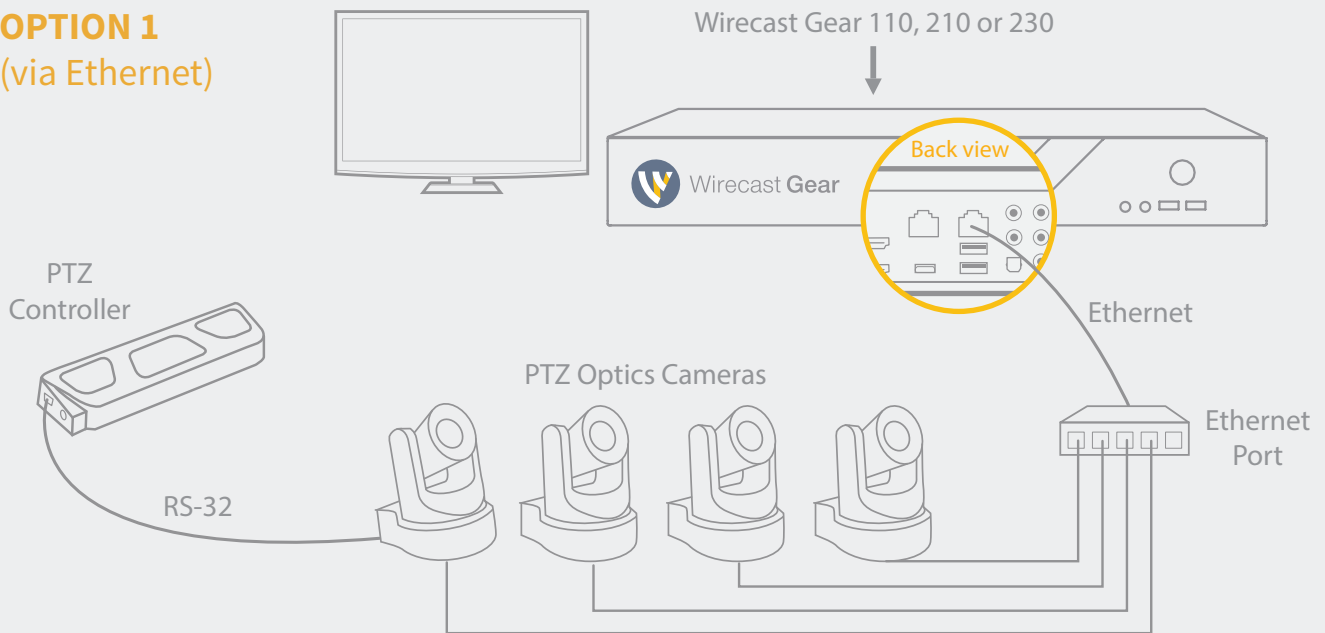

OPTION 2 (via SDI)

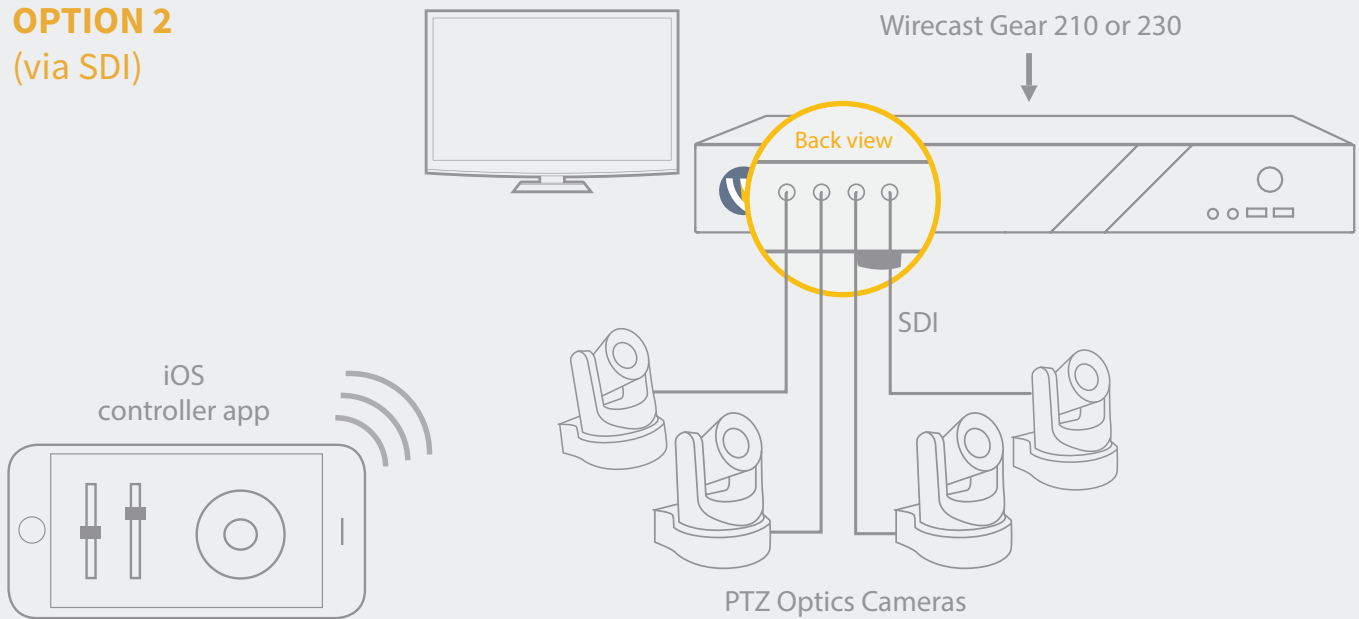

“The Hybrid” | HD-SDI + HDMI + Network

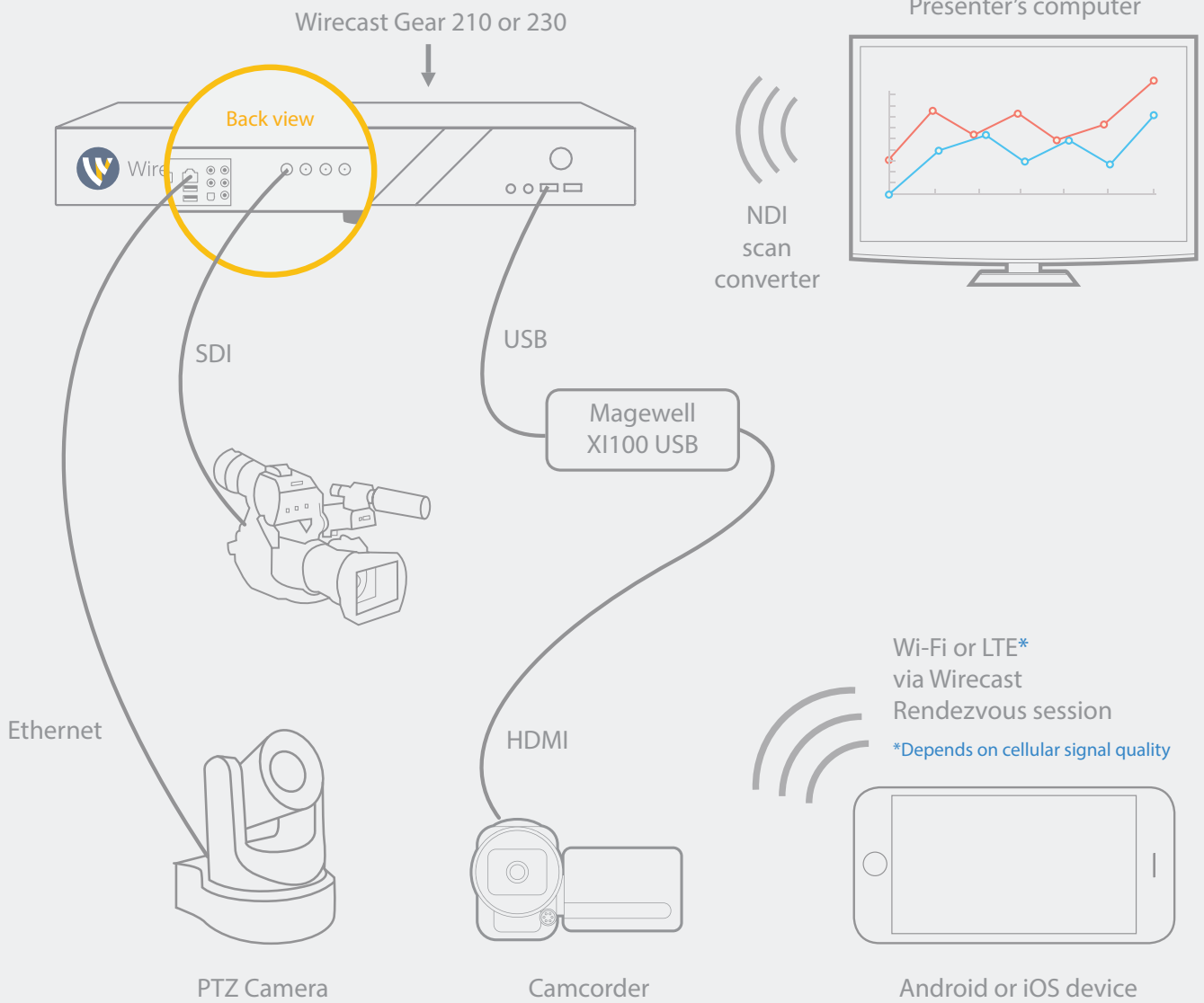

“The Serious Pro” | SDI + NDI + Audio Interface

